

# NDI DM DJ DL Series Dip Switches

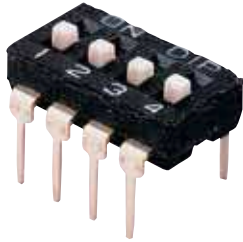

## SPECIFICATIONS

SWITCH FUNCTION: SPST, 1 thru 12 positions.

CONTACT RATING: Switch : 25 mA @ 24VDC.  
Carry : 100 mA @ 50VDC.

INSULATION RESISTANCE: 100M $\Omega$  min @ 500 VDC.

CONTACT RESISTANCE: Initial : 50m $\Omega$  @ 2-4VDC @ 100mA.  
After Life : 100m $\Omega$  @ 2-4VDC @ 100mA.

OPERATING LIFE: 2,000 make-and-break cycle each circuit.

OPERATING FORCE: 1000gf max.

TRAVEL, ACTUATOR: 1.0mm typical.

DIELECTRIC STRENGTH: 500 V RMS min @ seal level  
between adjacent terminals.

CAPACITANCE: 5pf max. between adjacent terminals.

TEMPERATURE RANGE: Operating/Storage : -40° C to 85° C.

VIBRATION: To MIL-STD-202F. Method 201A.

SHOCK: To MIL-STD-202F. Method 213B, Condition A.

SOLDERING RECOMMENDATION: Wave : 500° F(260° C) for 5 sec max. Hand : 30W soldering iron @ 608° F(320° C) for 2s typical. Keep all switches in the "OFF" position during soldering and cleaning process.

## HOW TO ORDER

Model No.	Actuator	NO. of Positions	Pin Spacing	Seal
NDI	R	01,02 04,06 08,10 11,12	H=7.62 mm Straight Pin S=9.84 mm Splay IC Pin	Tube Qty. T=Top Tape Seal*  Recessed Actuat or only
DM		01,02 03,04 05,06 07,08 09,10 12	(None)=Std.	(None)Std. Tube Qty. T=Top Tape Seal T/R=Tape and Reel w/Top Tape Seal*
DJ				
DL				

\*Top Tape Seal not available for 01 position or extended actuator

# NDI DM DJ DL Series Dip Switches

## ACTUATOR OPTION

R RECESSED

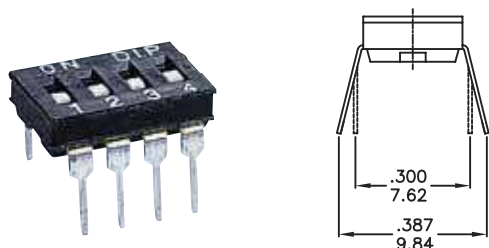

N EXTENDED

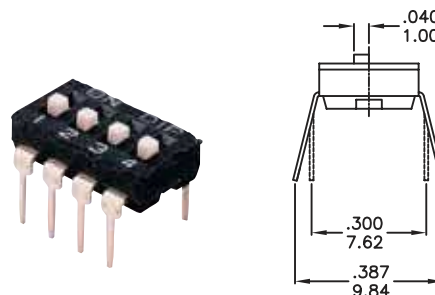

## NUMBER OF POSITIONS

"A" and "B" Dimension by Position

Positions	1	2	3	4	5	6	7	8	9	10	12
" A " Dimension	3.84 (.137)	6.02 (.237)	8.56 (.337)	11.10 (.437)	13.64 (.537)	16.18 (.637)	18.72 (.737)	21.26 (.837)	23.80 (.937)	26.34 (1.037)	31.421 (1.237)
" B " Dimension		2.54 (.100)	5.08 (.200)	7.62 (.300)	10.16 (.400)	12.7 (.500)	15.24 (.600)	17.78 (.700)	20.32 (.800)	22.86 (.900)	27.94 (1.100)

Position Availability by Termination Option

Positions	1	2	3	4	5	6	7	8	9	10	12
2)Gold Gull Wing SMT	X	X	X	X	X	X	X	X	X	X	X

# NDI DM DJ DL Series Dip Switches

## TERMINATION / PIN SPACING OPTIONS

H STRAIGHT (FOR MANUAL INSERTION)

NDI

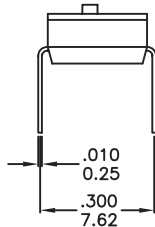
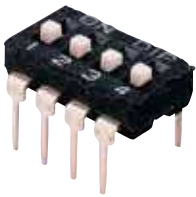

H STRAIGHT

7.62mm Spacing

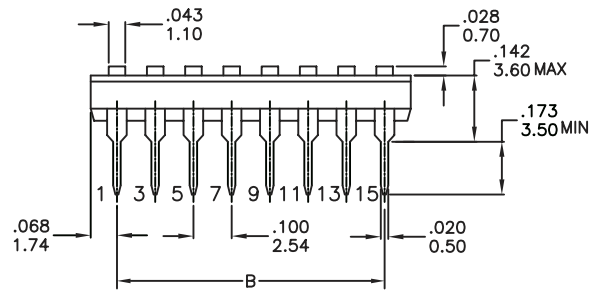
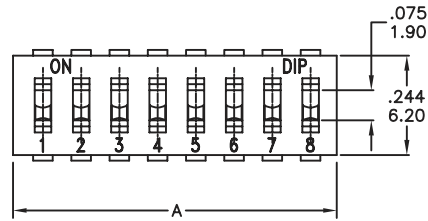

Position 1 denotes Pin NO. 1.

S SPLAY (FOR IC MACHINE INSERTION)

NDI

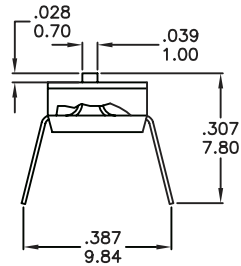
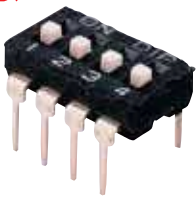

S SPLAY

9.84mm Spacing

SCHEMATIC

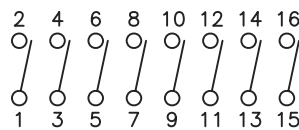

P.C.MOUNTING

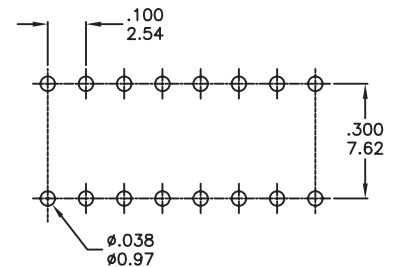

SCHEMATIC

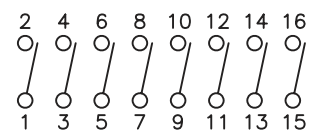

PCB MOUNTING

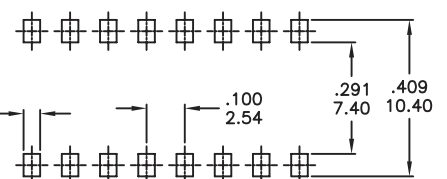

Position 1 denotes Pin NO. 1.

DM

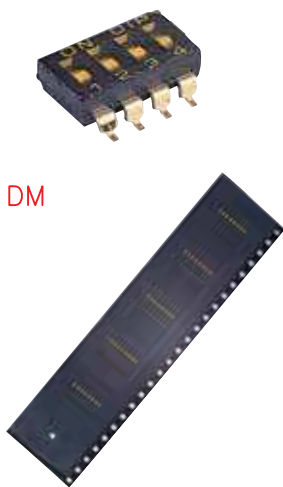

Gull Wing

# NDI DM DJ DL Series Dip Switches

## PACKAGING / SEAL OPTIONS

T TOP TAPE  
SEALED\*



R TAPE AND REEL WITH TOP TAPE SEAL (SMT TERMINATION "2" ONLY)



POS.	Tape Size(W)
1	16mm
2	16mm
3	16mm
4	24mm
5	24mm
6	24mm
7	32mm
8	32mm
9	44mm
10	44mm
12	44mm

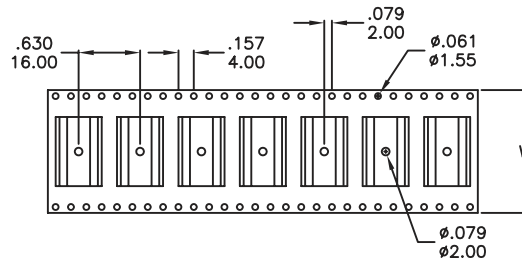

Pitch:16mm  
Reel Quantity:900pcs.

\*Top Tape Seal for recessed Actuator only.  
01 Position switches not available with Top Tape Seal.