

7A Series

Sealed Snap-Acting Pushbutton Switches



SPECIFICATIONS

- CONTACT RATING:** Dependent upon contact material.
- MECHANICAL LIFE:** 50,000 make-and-break cycles at full load.
- CONTACT RESISTANCE:** 20mΩ max.initial @ 2-4 VDC.
100mA, for both silver and gold plated contacts.
- INSULATION RESISTANCE:** 1,000MΩ min.
- DIELECTRIC STRENGTH:** 1,500 V RMS min. @sea level.
- OPERATING TEMPERATURE:** -30°C to 85°C.
- CAP INSTALLATION FORCE:** 10 lbs, max. permissible.

MATERIALS

- CASE & BUSHING:** Glass filled nylon 6/6, flame retardant, heat stabilized(94V-O)
- PLUNGER:** Glass filled nylon or glass filled polyester(UL 94V-O)
- SWITCH SUPPORT:** Brass or steel, tin plate.
- SWITCH SUPPORT RETAINER:** Stainless steel.
- N.O.&N.C. CONTACTS:** Brass, with gold plate over nickel plate.
- COMMON CONTACTS & ALL TERMINALS:** Copper alloy, with gold plate over nickel plate. (See Page 116)

TERMINAL SEAL: Epoxy.

HOW TO ORDER

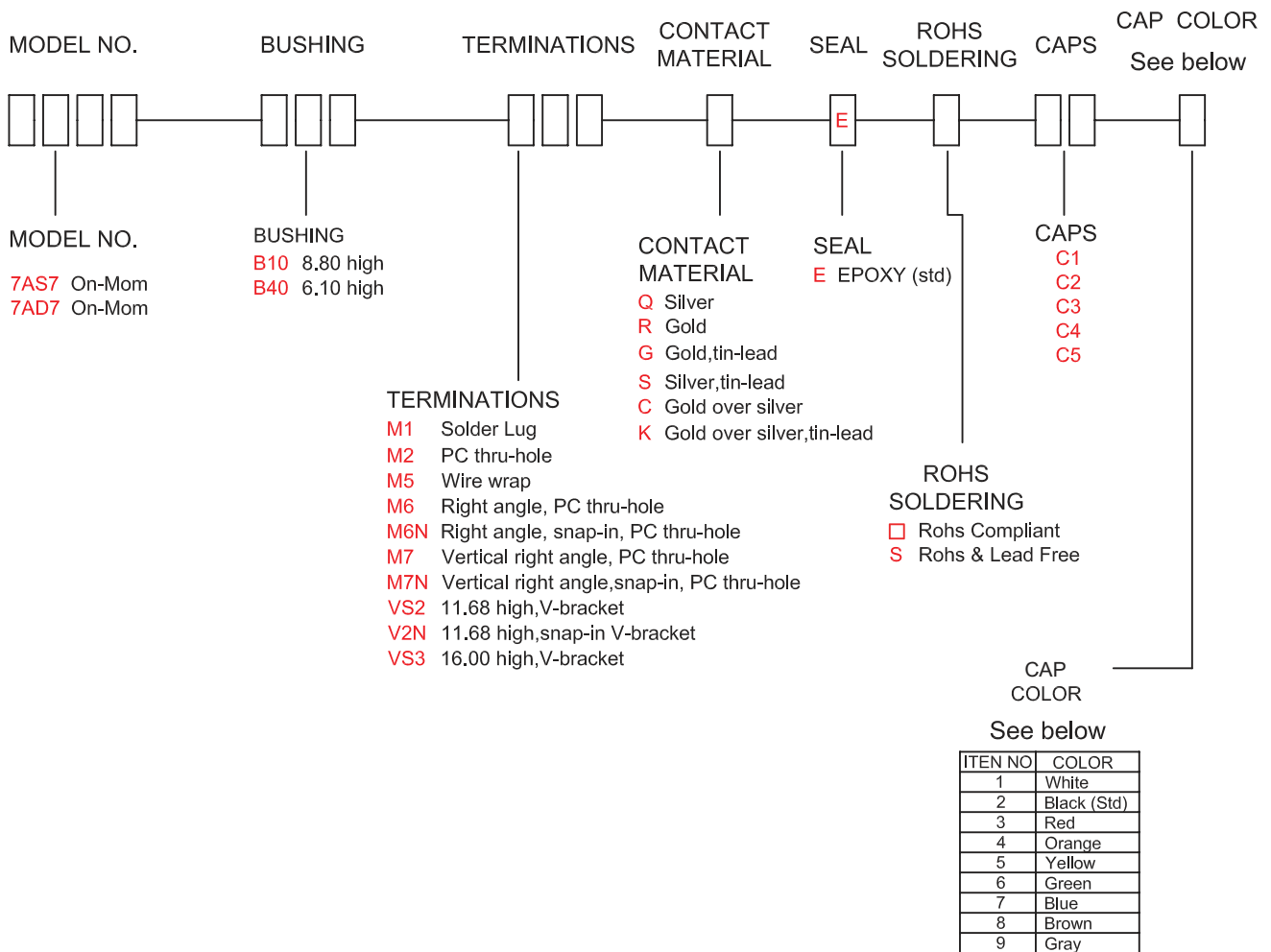

7A Sealed Snap-Acting Pushbutton Switches

SWITCH FUNCTION

NO. POLES	UL/CSA MODEL NO.	MODEL NO.	SWITCH FUNCTION		CONNECTED TERMINALS		SCHEMATIC
			POS.1	POS.2	POS.1	POS.2	
SP	Q27A17	7AS7	ON	MOM	1-3	1-2	
DP	Q27A27	7AD7	ON	MOM	1-3,4-6	1-2,4-5	

MOM=MOMENTARY

POLE OPTIONS

M1

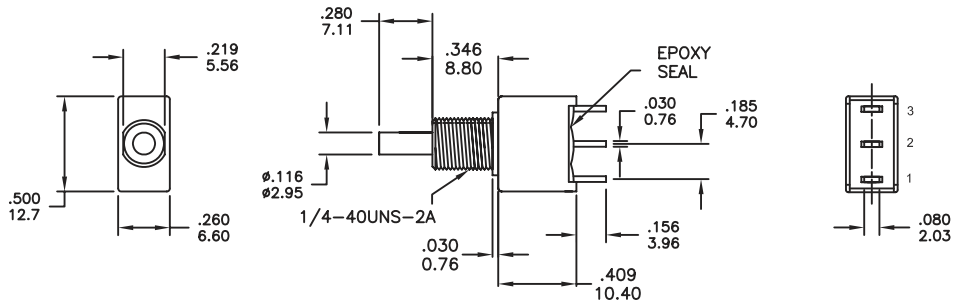

SPDT

Part No. Shown : 7AS7B10M1RE

M1

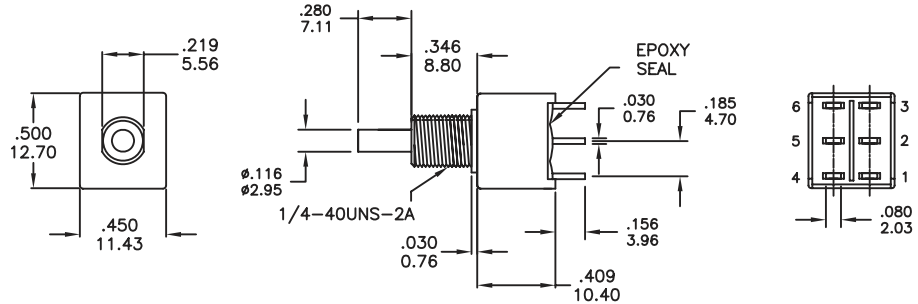

DPDT

Part No. Shown : 7AD7B10M1RE

BUSHING OPTIONS

B10

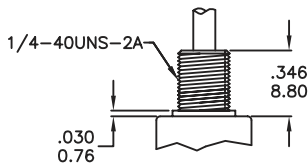

Std for M1

B40

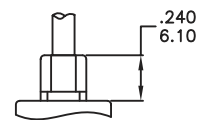

Std for M2, M6, M7, VS termination

TERMINATION OPTIONS

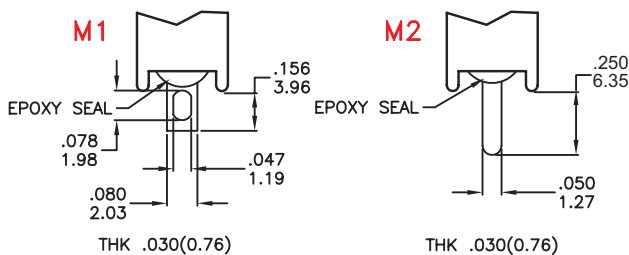

M6 RIGHT ANGLE P.C. MOUNT

M7 RIGHT ANGLE P.C. MOUNT

VS2 VERTICAL BRACKET P.C. MOUNT

VS3 VERTICAL BRACKET P.C. MOUNT

7A Series

Sealed Snap-Acting Pushbutton Switches

M6

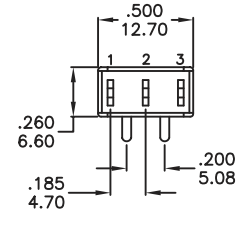
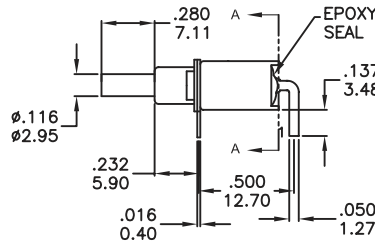
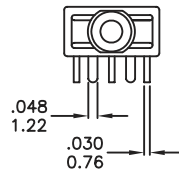

P.C. MOUNTING

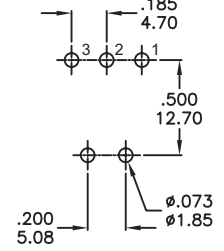

SPDT

Part No. Shown : 7AS7B40M6RE

SECTION A-A
TERM.NOS.FOR
REFERENCE ONLY

M6

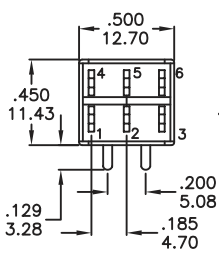
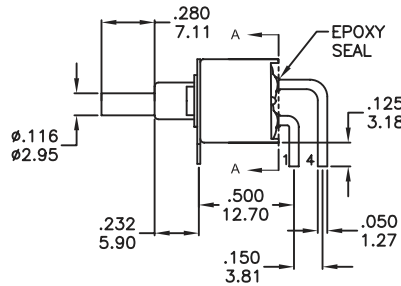
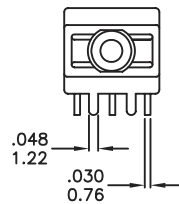
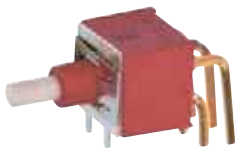

P.C. MOUNTING

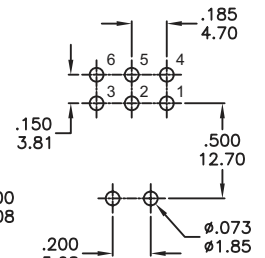

DPDT

Part No. Shown : 7AD7B40M6RE

SECTION A-A
TERM.NOS.FOR
REFERENCE ONLY

M7

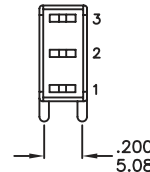
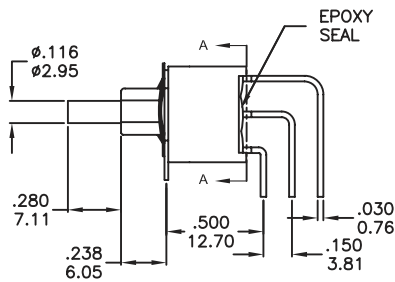
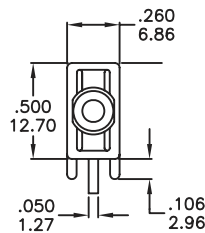

P.C. MOUNTING

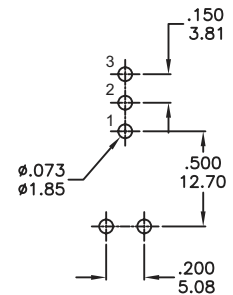

SPDT

Part No. Shown : 7AS7B40M7RE

SECTION A-A
TERM.NOS.FOR
REFERENCE ONLY

M7

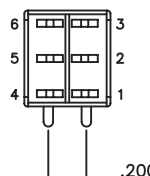
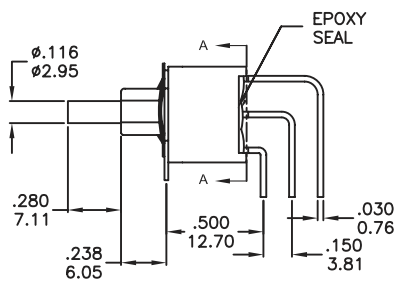
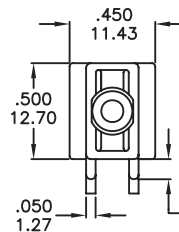

P.C. MOUNTING

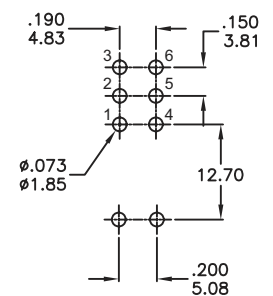

DPDT

Part No. Shown : 7AD7B40M7RE

SECTION A-A
TERM.NOS.FOR
REFERENCE ONLY

7A Sealed Snap-Acting Pushbutton Switches

7A Series

Sealed Snap-Acting Pushbutton Switches

VS2-VS3

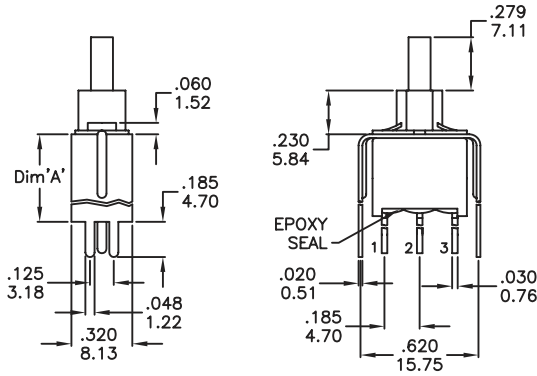

OPTION CODE	DIM. 'A'
VS2	.460 11.68
VS3	.630 16.00

P.C. MOUNTING

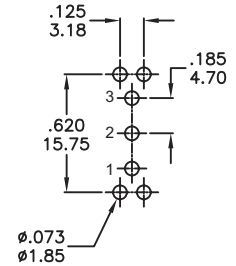

SPDT

Part No. Shown : 7AS7B40VS2RE

VS2-VS3

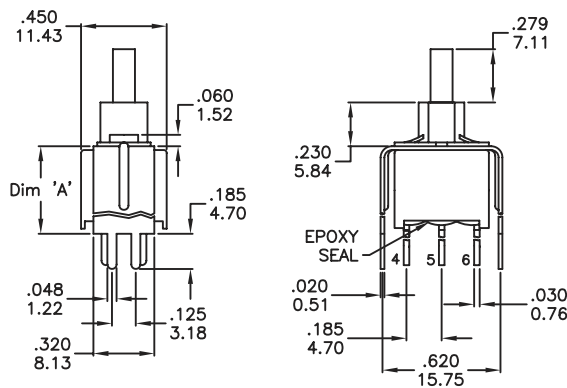

OPTION CODE	DIM. 'A'
VS2	.460 11.68
VS3	.630 16.00

P.C. MOUNTING

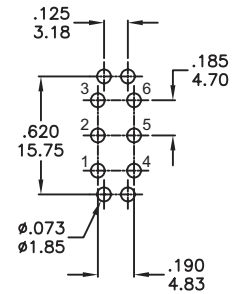

DPDT

Part No. Shown : 7AD7B40VS2RE

SNAP-IN TERMINATION OPTIONS

M6N

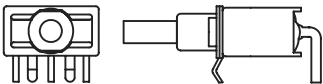

M7N

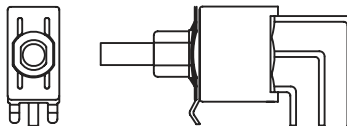

V2N

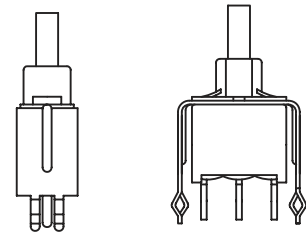

CONTACT MATERIAL OPTIONS

	CONTACT MATERIAL	TERMINATION RATING	RATINGS
Q	Silver	Q = Gold flash over silver	3 Amps with resistant load @ 120VAC or 28VDC 1 Amps with resistant load @ 250VAC
S		S = Gold flash over silver, pure - tin	
C	Gold over Silver	C = Gold over silver	
K		K = Gold over silver, pure - tin	
R	Gold	R = Gold	0.4 Volt-Amps(VA)max. @ 20V max. (AC or DC)
G		G = Gold, pure - tin	



IP 67
 ACCORDING TO
 EN 60529:1991+A1:2001
 IEC 60529:2001

SOLDERING PROCESSES

MANUAL SOLDERING : Use soldering iron of 30 watts, controlled at 350°C approximately 5 seconds while applying solder.

WAVE SOLDERING : Recommended Soldering Temperature: 260±5°C
 Duration of Solder Immersion: 5 ±1 seconds
 (PCB is 1.6mm in thickness)

SOLDERING : Vapor phase

Temperature Profile

Zone	Room temperature	Time (Sec)
Pre-heat (A)	150°C	Min 120s
Soak (B)	180°C~200°C	Min 150s
Peak (C)	200°C~235°C	Min 30s
Peak (D)	235°C~260°C	Min 40s
Peak (E)	260°C	Max 10s

