



### SPECIFICATIONS

**CONTACT RATING:** Dependent upon contact material.  
**MECHANICAL LIFE:** 30,000 make-and-break cycles.  
**CONTACT RESISTANCE:** 20mΩ max. initial @ 2-4VDC  
 100mA for both silver and gold plated contacts.  
**INSULATION RESISTANCE:** 1,000M Ω min.  
**DIELECTRIC STRENGTH:** 1,000 V RMS@sea level.  
**OPERATING TEMPERATURE:** -30°C to 85°C

### MATERIALS

**CASE & BUSHING** - Glass filled nylon 4/6, flame retardant, heat stabilized ( UL 94V-0 )  
**ACTUATOR** - Brass, chrome plated, internal O-ring seal. Standard for all actuators.  
**SWITCH SUPPORT** - Brass, tin plated.  
**CONTACT/TERMINALS** - Copper alloy, with Silver or gold plated. (See Page 40)

## HOW TO ORDER

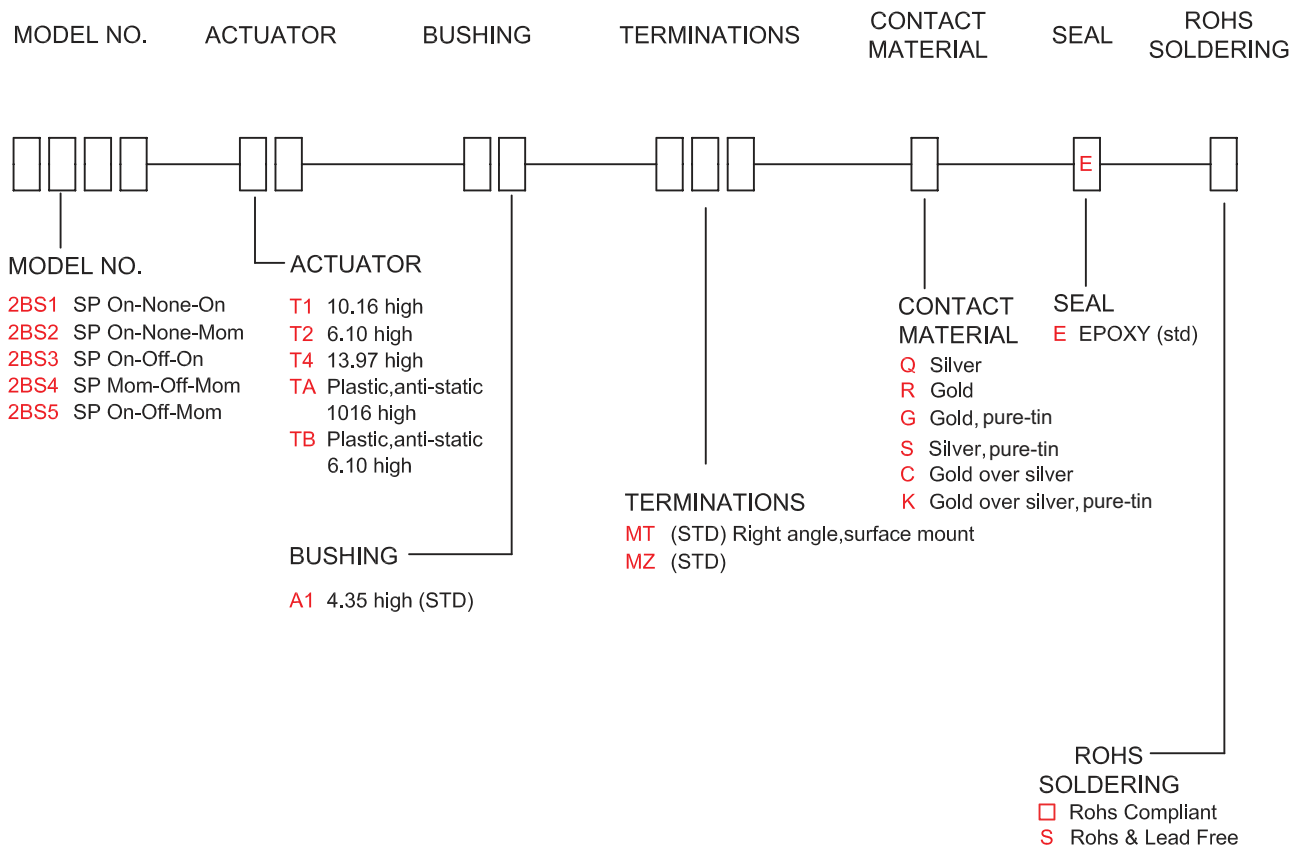

### SWITCH FUNCTION

NO. POLES	UL-CSA	MODEL NO.	SWITCH FUNCTION			CONNECTED TERMINALS / SCHEMATIC		
			POS.1	POS.2	POS.3	POS.1	POS.2	POS.3
SP	Q22B11	2BS1	ON	NONE	ON	2-3 	OPEN	2-1 
	Q22B12	2BS2	ON	NONE	MOM			
	Q22B13	2BS3	ON	OFF	ON			
	Q22B14	2BS4	MOM	OFF	MOM			
	Q22B15	2BS5	ON	OFF	MOM			

### POLE OPTIONS

#### MT

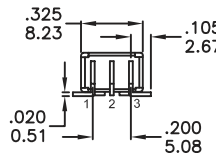
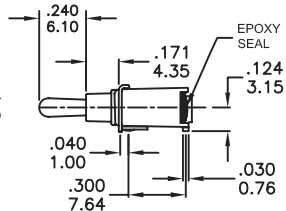
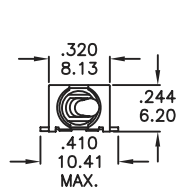

#### P.C. MOUNTING

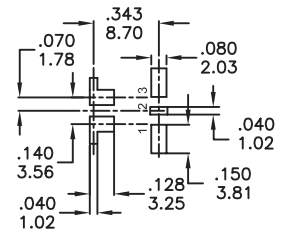

#### SPDT

Part No. shown : 2BS1T2A1MTRE

#### MZ

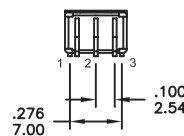
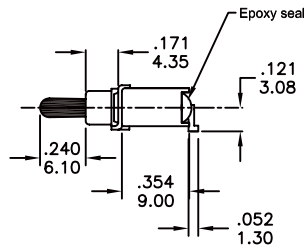
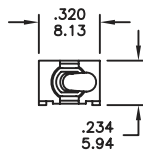

#### P.C. MOUNTING

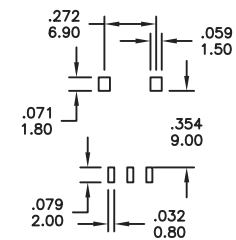

#### SPDT

Part No. shown : 2BS1TBA1MZRE

### ACTUATOR OPTIONS

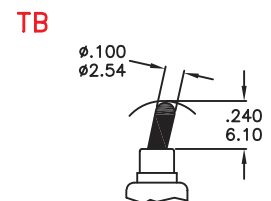
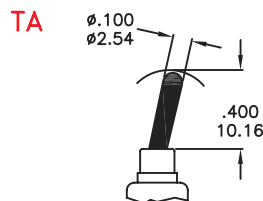
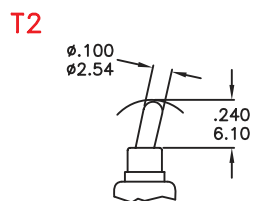
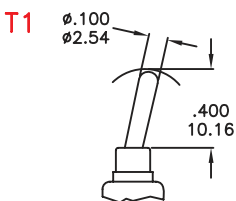

ESD PLASTIC ACTUATOR

### PACKAGING

Switches available on embossed antistatic tape and reels.  
Tape and cover strip are conductive for use near statically sensitive components.

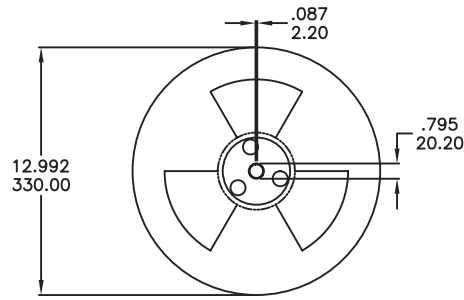
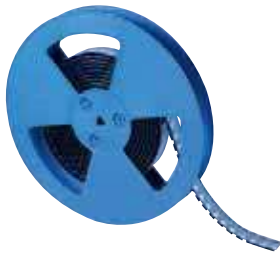

SCALE: 10 : 1

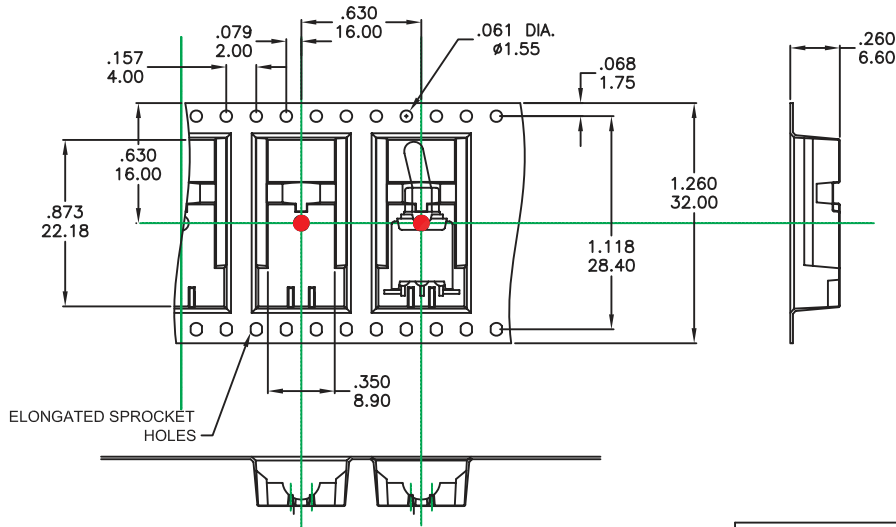
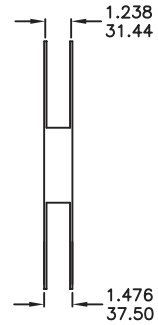

SCALE: 1 : 1

REEL INFORMATION	
QUANTITY PER REEL	500 PCS

### CONTACT MATERIAL OPTIONS

	CONTACT MATERIAL	TERMINATION RATING	RATINGS
<b>Q</b>	<b>Silver</b>	<b>Q</b> = Gold flash over silver	3 Amps with resistant load @ 120VAC or 28VDC 1 Amps with resistant load @ 250VAC
<b>S</b>		<b>S</b> = Gold flash over silver,pure - tin	
<b>C</b>	<b>Gold over Silver</b>	<b>C</b> = Gold over silver	
<b>K</b>		<b>K</b> = Gold over silver,pure - tin	
<b>R</b>	<b>Gold</b>	<b>R</b> = Gold	0.4 Volt-Amps(VA)max. @ 20V max. (AC or DC)
<b>G</b>		<b>G</b> = Gold,pure - tin	



**IP 67**  
 ACCORDING TO  
 EN 60529:1991+A1:2001  
 IEC 60529:2001

### SOLDERING PROCESSES

**WAVE SOLDERING** : Recommended Soldering Temperature:260±5°C  
 Duration of Solder Immersion: 5 ±1 seconds  
 (PCB is 1.6mm in thickness)

**SOLDERING** : Vapor phase & IR- reflow soldering can be applied.

### Temperature Profile

Zone	Room temperature	Time ( Sec )
Pre-heat ( A )	150°C	Min 120s
Soak ( B )	180°C~200°C	Min 150s
Peak ( C )	200°C~235°C	Min 30s
Peak ( D )	235°C~260°C	Min 40s
Peak ( E )	260°C	Max 10s

