

PCB TAB Terminals

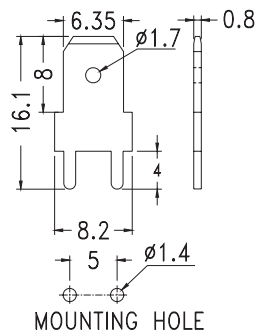

- MATERIAL: TIN PLATED BRASS
- UNIT: mm

PART NO	PACKAGE
YPPCC250	1000

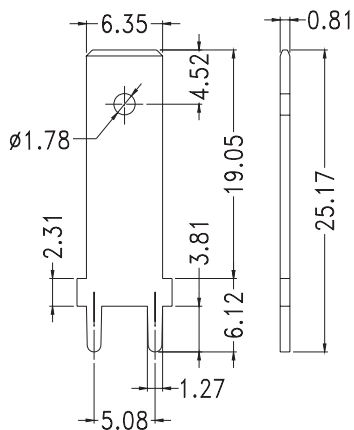
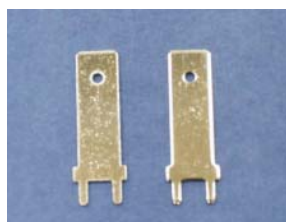

- MATERIAL: TIN PLATED BRASS
- UNIT: mm

PART NO	PACKAGE
YPPCC250-4	1000

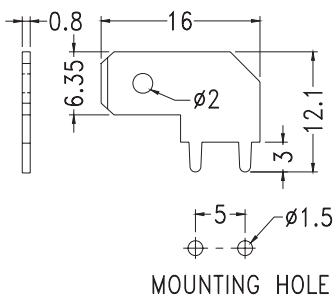
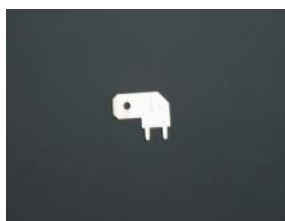

- MATERIAL: TIN PLATED BRASS
- UNIT: mm

PART NO	PACKAGE
YPPCCF250	1000

PCB TAB Terminals

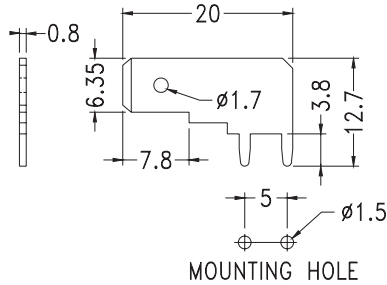

PART NO	PACKAGE
YPCCFL250	1000

- MATERIAL: TIN PLATED BRASS
- UNIT: mm

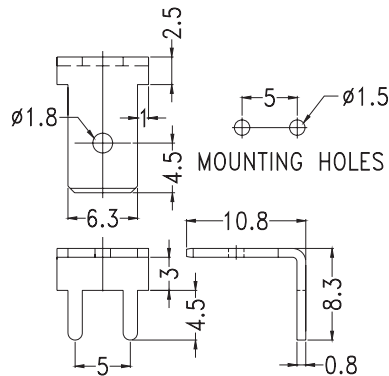

PART NO	PACKAGE
YPPCC1L250-1A	1000

- MATERIAL: TIN PLATED BRASS
- UNIT: mm

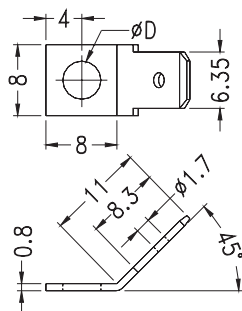

PART NO	D	PACKAGE
YPPCC1L250	4.3	1000
YPPCC1L25005	5.3	

- MATERIAL: TIN PLATED BRASS
- UNIT: mm